

Liagò

LIVING STORAGE UNITS

2020

Piero Lissoni



Description

Ideal for the dining and living areas, the Liagò collection consists of two low storage units with doors and drawers and a tall storage unit with hinged or flap doors. Defined by clear lines and increased thicknesses, these units are inspired by the Venetian architectural element (an outdoor loggia made of wood, often featuring a marble floor) after which they have been named. Just like a building, the 50mm-thick frame of the units hides a functional soul: side and back panels are assembled by means of a “folding” mechanism to create an internal compartment, allowing the passage of electrical cables and other elements. This means that the units can accommodate power supply cables and connections for televisions, monitors, lamps, speakers and other wired devices. Whether placed directly on the floor or raised on steel feet, the Liagò storage units are available in different woods and lacquered in numerous glossy and satin shades, with the marble option for the tops. The interiors are covered with a silky, anti-scratch, anti-fingerprint, matt anthracite material, while the shelves are made of smoked etched glass. The project also includes drawers with an incredibly thin frame and accessories such as pull-out trays in grey Canaletto walnut, guaranteeing additional customisation and versatility. Liagò can be equipped with an internal lighting system and one for the high storage unit’s open compartment. This solution underscores the exceptional elegance of the interiors and allows the objects contained therein to be displayed at best.

Technical information

External frame (sides, back panel and base)

veneered MDF wood fibre panel

Door and drawer front

veneered MDF wood fibre panel or marble (matt natural finish or gloss natural finish)

Base-frame

steel profiles

Feet

plastic material

Shelf

glass

Extractable tray and cutlery holder

veneered MDF wood fibre

Internal drawer

bottom base and back panel in wood particles with melamine faced cover, edges in aluminium with complete opening and cushioned runners

LED lighting system

Strip LED 24V DC 3000K

- Power supply unit: input voltage 110-240V 50-60Hz, output voltage 12-24V DC, maximum wattage 18W-48W
- Switch with presence sensor with electronic power supply unit: voltage 110-240V 50-60Hz

Technical drawings

LG250_1

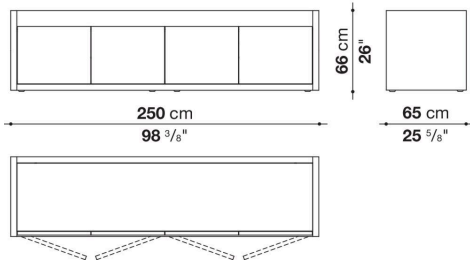

LGB250_1

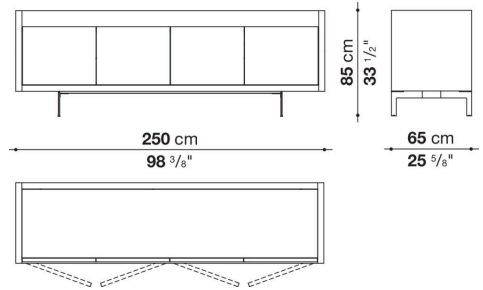

LG250_2

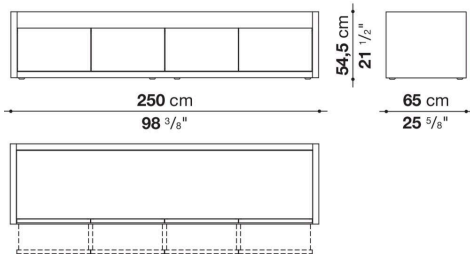

LGB250_2

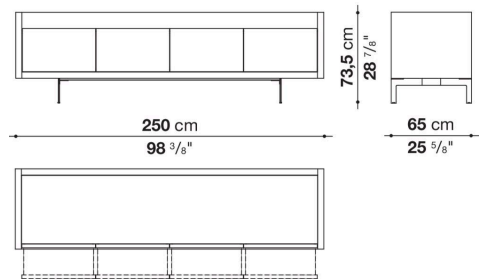

LG250_3

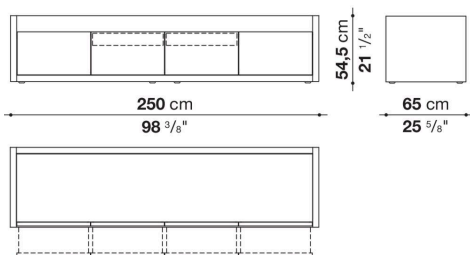

LGB250_3

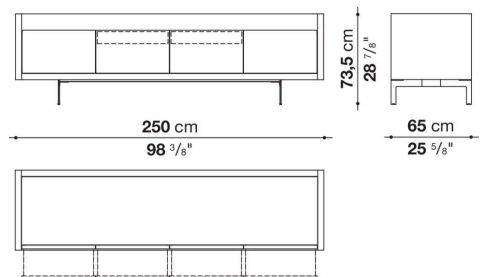

LG250_4

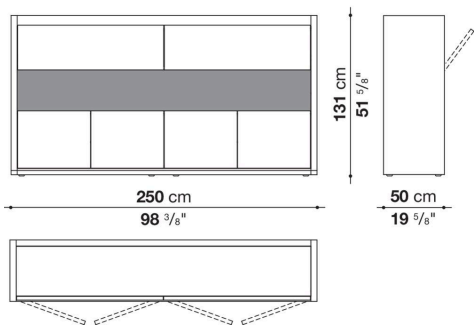

LGB250_4

